



VLA1918LP

Directional Antenna



Technical Characteristics	
Frequency	2.0-2.5 GHz
Impedance	50 Ω
VSWR Max.	<2.0 : 1
Polarization	Linear, Vertical
Antenna Gain	17.5 dBi @ 2.0 GHz 18.0 dBi @ 2.5 GHz
3dB Beamwidth Vertical	6.4° @ 2.0 GHz 5.5° @ 2.5 GHz
3dB Beamwidth Horizontal	62.8° @ 2.0 GHz 58° @ 2.5 GHz
Dimensions (L x W x D)	48.25" L x 6.30" W x 2.30" Thick (122.55 x 16 x 5.90 cm)
Weight	15 lbs., 6.8 Kg
Connector	N(f)
Windload	80 N (at 160 Km/h) (Est.)
Radome Material	Glass fibre
Operating Conditions	-40°C to +60° C
Color	Gray

> Performance

The VLA1918LP is a high-gain directional antenna. It combines the benefits of 18 dBi antenna gain with a horizontal HPW of 64° and, therefore, fits best with all BMS diversity receive systems.

The VLA1918LP high gain panel antenna is the smart way of improving coverage and reliability without resorting to higher output power.

- High gain directional antenna with linear polarization
- Field-proven performance
- Advanced antenna design
- High gain for maximum range
- Superior directivity
- Rugged construction

> Included Accessory

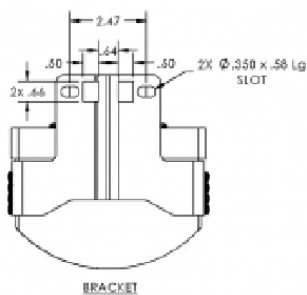
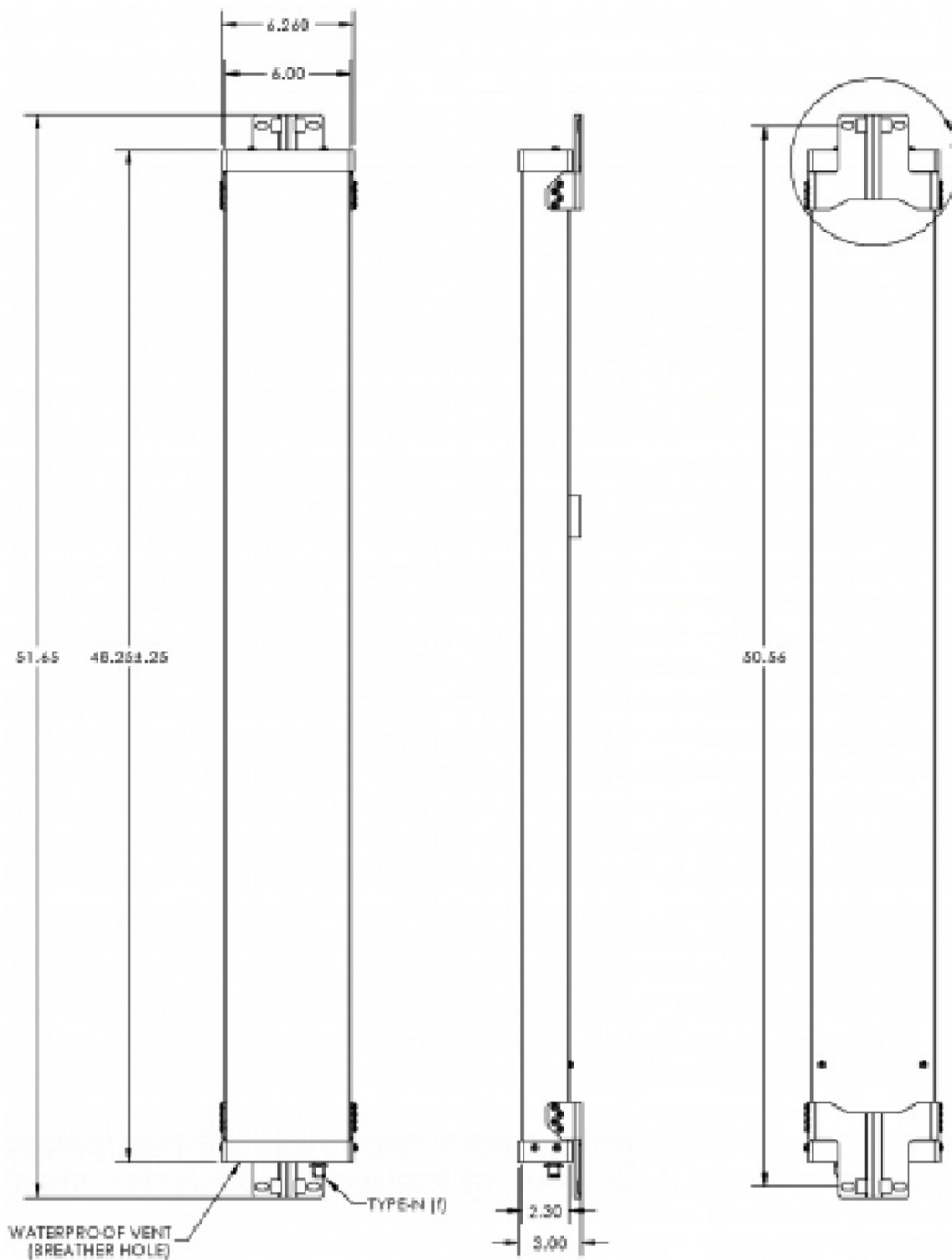

Ordering Information

8714480002 | VLA1918LP | Includes mount and tilt bracket

Contact factory about other BMS antenna options