



# VLA1918LP

## Directional Antenna



Technical Characteristics	
Frequency	2.0-2.5 GHz
Impedance	50 $\Omega$
VSWR Max.	<2.0 : 1
Polarization	Linear, Vertical
Antenna Gain	17.5 dBi @ 2.0 GHz 18.0 dBi @ 2.5 GHz
3dB Beamwidth Vertical	6.4° @ 2.0 GHz 5.5° @ 2.5 GHz
3dB Beamwidth Horizontal	62.8° @ 2.0 GHz 58° @ 2.5 GHz
Dimensions (L x W x D)	48.25" L x 6.30" W x 2.30" Thick (122.55 x 16 x 5.90 cm)
Weight	15 lbs., 6.8 Kg
Connector	N(f)
Windload	80 N (at 160 Km/h) (Est.)
Radome Material	Glass fibre
Operating Conditions	-40°C to +60° C
Color	Gray

### > Performance

The VLA1918LP is a high-gain directional antenna. It combines the benefits of 18 dBi antenna gain with a horizontal HPW of 64° and, therefore, fits best with all BMS diversity receive systems.

The VLA1918LP high gain panel antenna is the smart way of improving coverage and reliability without resorting to higher output power.

- High gain directional antenna with linear polarization
- Field-proven performance
- Advanced antenna design
- High gain for maximum range
- Superior directivity
- Rugged construction

### > Included Accessory

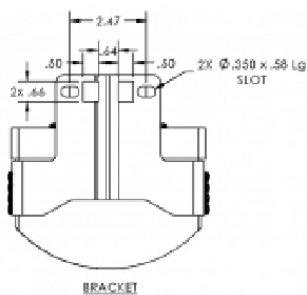
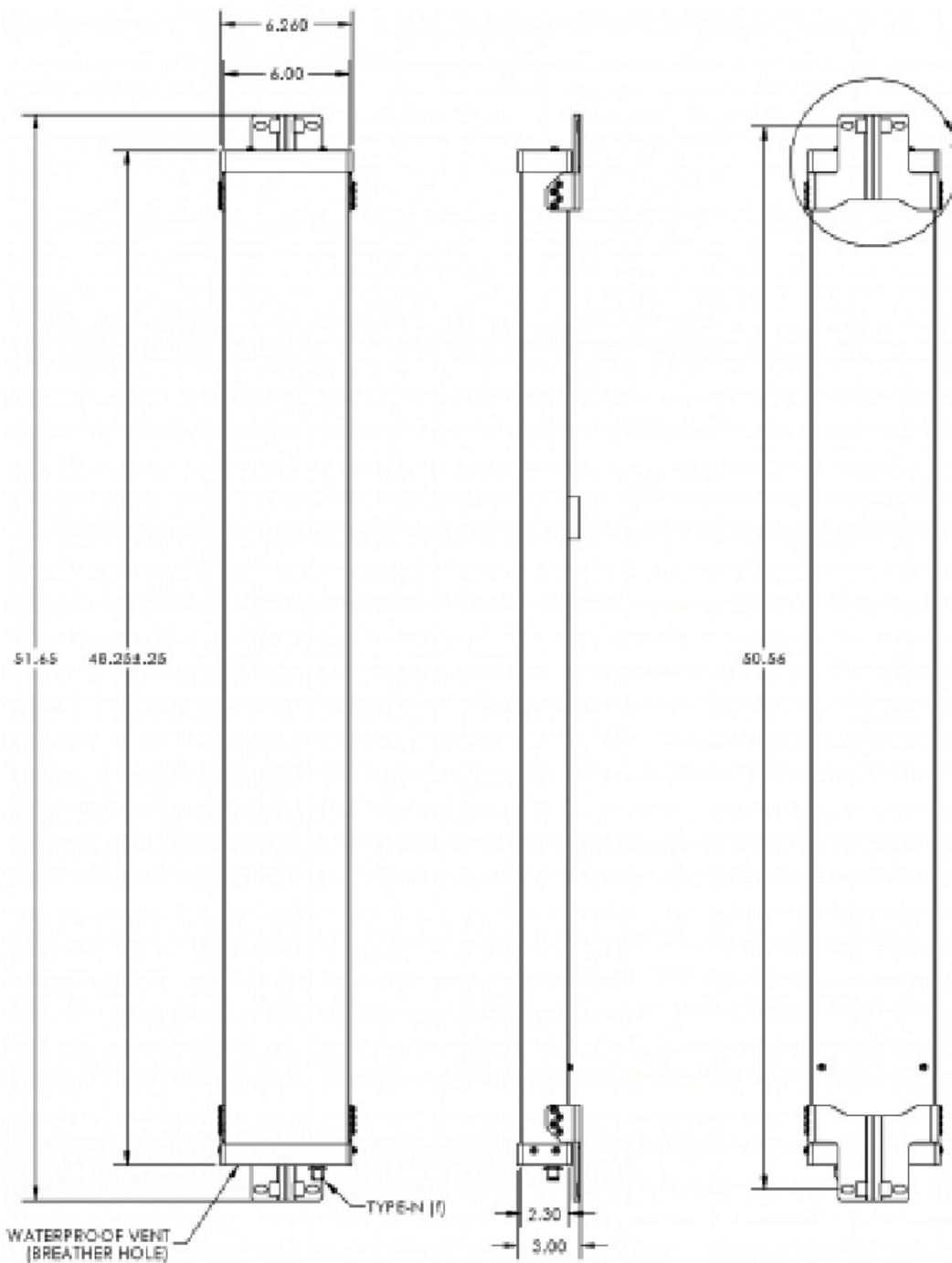

Ordering Information

8714480002 | VLA1918LP | Includes mount and tilt bracket

Contact factory about other BMS antenna options

Broadcast Microwave Services, Inc. reserves the right to make changes for the purposes of technical improvement. All rights reserved. | 050821  
 Broadcast Microwave Service Europe behält sich Änderungen vor, die dem technischen Fortschritt dienen. Alle Rechte vorbehalten!